

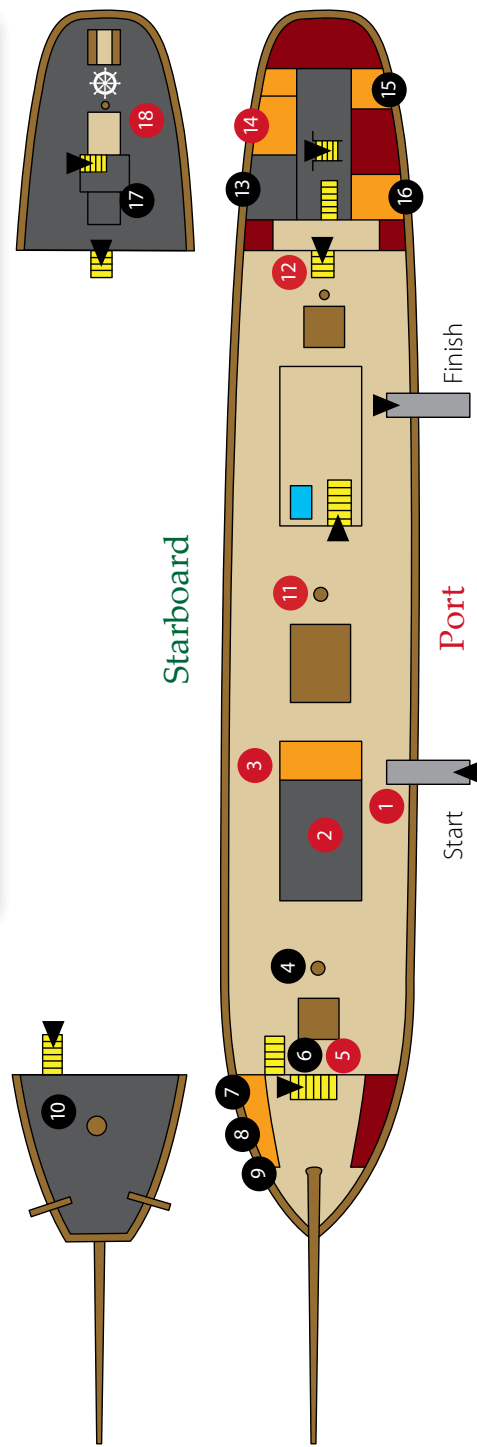

Glenlee deck plan

Weather deck

- Coffee and souvenirs
- Stairs
- Lift
- Audio stops
- Access not open to visitors
- Access not open to visitors but visible from route
- No wheelchair access
- + Highlights tour audio stops



Tween deck

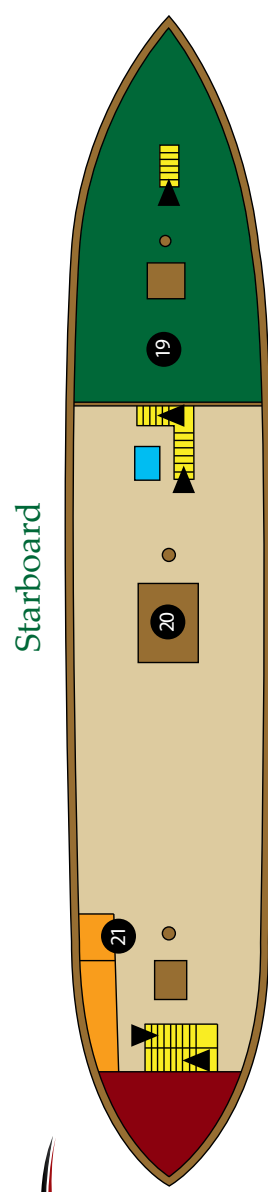

- 01 | Welcome
- 02 | Main deckhouse
- 03 | Galley
- 04 | Fore mast
- 05 | Bell
- 06 | Anchor chains
- 07 | Carpenter
- 08 | The Heads
- 09 | Hospital
- 10 | Foc'sle deck
- 11 | Main mast
- 12 | Poop cabin

- 13 | Apprentice cabin
- 14 | Saloon
- 15 | Pantry
- 16 | First mate's cabin
- 17 | Chart room
- 18 | Wheel

- 19 | Tween deck
- 20 | Main hatch
- 21 | Sailmaker



Cargo hold



- Access not open to visitors
- Access not open to visitors but visible from route
- No wheelchair access

Starboard

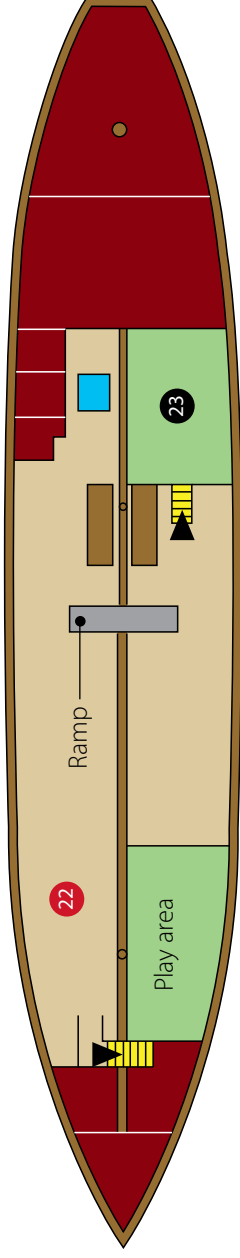

Port

Lower deck

Starboard

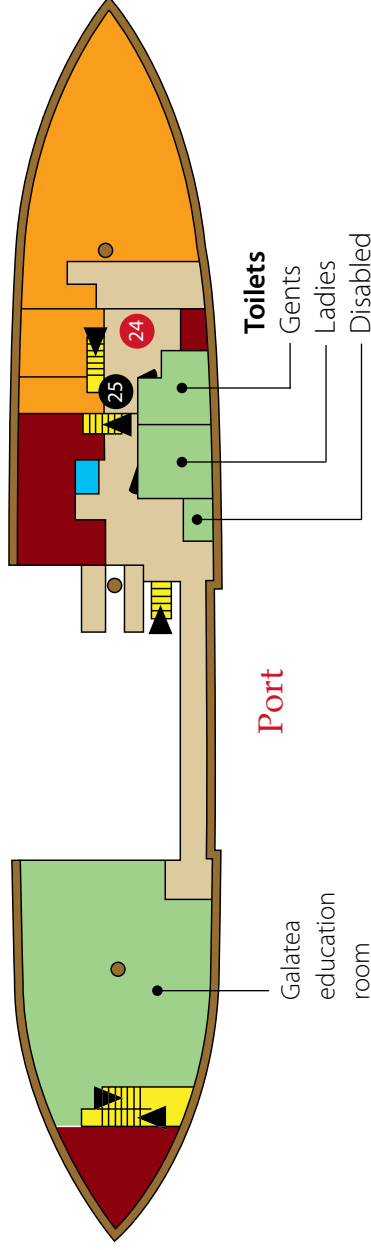

Port

22 | Cargo hold

23 | Cargo cinema

24 | Engine room

25 | Thank you

Welcome aboard!

Built in 1896, The Tall Ship, Glenlee, is one of a handful of surviving sailing ships built here on the River Clyde in their hundreds!

Glenlee has been fully restored ready for you to step aboard for a voyage of discovery through time.

Not to be missed!

- » take a tour of the ship with one of our all-new audio guides
- » visit the refurbished captain's cabin
- » enjoy our on-board children's play area for under-5s
- » see the restored engine room, installed during the Spanish era
- » watch rare film footage of The Tall Ship at sea
- » put your questions to our working ship's crew
- » take part in our mouse hunt!

Ask us about hiring The Tall Ship for your next event!

Call **0141 357 3699** for more information.

